

INSTRUCTION MANUAL

S14HW, HD, 14" x 103"

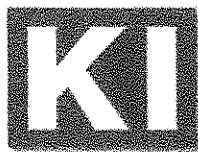
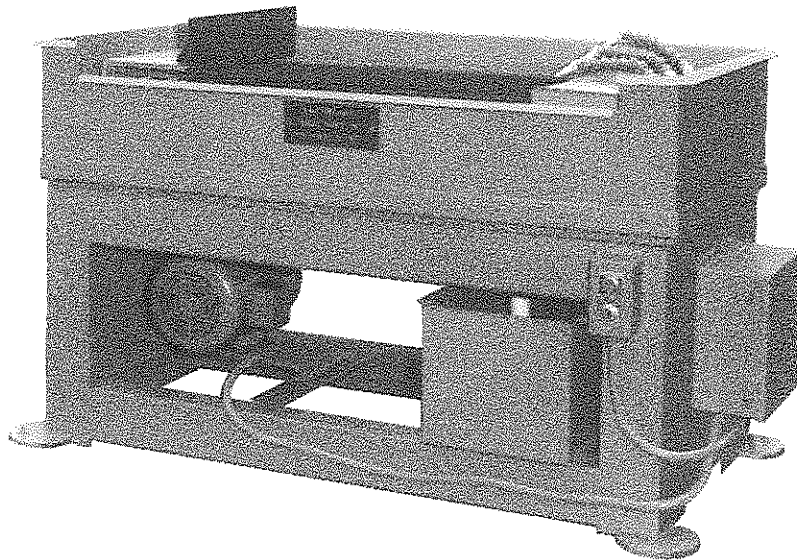

**KALAMAZOO
INDUSTRIES, INC.**

6856 East K Avenue
Kalamazoo, MI 49048

269-382-2050 PH

269-382-0790 FAX

www.kalamazooindustries.com

WARRANTY

All products are guaranteed for a period of one year to the original purchaser, against defects in material workmanship under normal use. Electric motors are warranted by the motor manufacturer and will be repaired by the nearest motor repair station. If non-repairable, they will be replaced by Kalamazoo Industries. Please call for instructions 269-382-2050.

RETURN POLICY

Authorization must be obtained before returning merchandise. Please call our customer service department for a return authorization number at 269-382-2050. Please include with your return a copy of your invoice or packing slip. Materials must be sent back prepaid. (Unless otherwise indicated). All returns will be subject to a 10% restocking charge. No returns will be accepted after one year of invoice date.

BELT SANDER SAFETY

- READ THE OPERATING INSTRUCTIONS BEFORE RUNNING MACHINE.
- ALWAYS WEAR SAFETY GLASSES OR A FULL FACE SHIELD FOR PROTECTION.
- KEEPS HANDS CLEAR OF THE SANDING AREA.
- NEVER WEAR GLOVES OR LOOSE FITTING CLOTHES WHEN OPERATING THIS MACHINE.
- ALWAYS KEEP HAIR TIED BACK OR COVERED.
- LET MACHINE ROTATION COME TO A FULL STOP BEFORE CHANGING BELT.
- KEEP SAFETY GUARDS IN PLACE. DO NOT ALTER GUARDS OR MACHINE IN ANY WAY. ANY ALTERATIONS TO GUARDS OR MACHINE COULD CAUSE SERIOUS INJURY.
- ALL BELT SANDERS SHOULD BE OPERATED IN A WELL-VENTILATED AREA. THE DUST CREATED WHEN SOME MATERIALS ARE SANDED CAN BE HARMFUL. DUST MASKS ARE RECOMMENDED AS A PRACTICAL MEANS OF MINIMIZING DUST INHALATION. FUMES FROM OTHER SOURCES CAN ALSO CAUSE FIRES WHEN IN CONTACT WITH SANDING SPARKS.
- SPARKS CREATED BY SANDING SHOULD BE DIRECTED DOWNWARD AND AWAY FROM THE FACE AND BODY. DO NOT GRIND NEAR FLAMMABLE MATERIAL.

KALAMAZOO INDUSTRIES, INC.
6856 East K Avenue
Kalamazoo, MI 49048
269-382-2050 PH
269-382-0790 FAX
www.kalamazooindustries.com

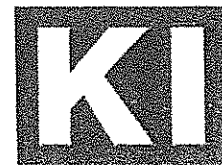

Made in USA

Models S14HD, S14HW 14" x 103" Belt Sander

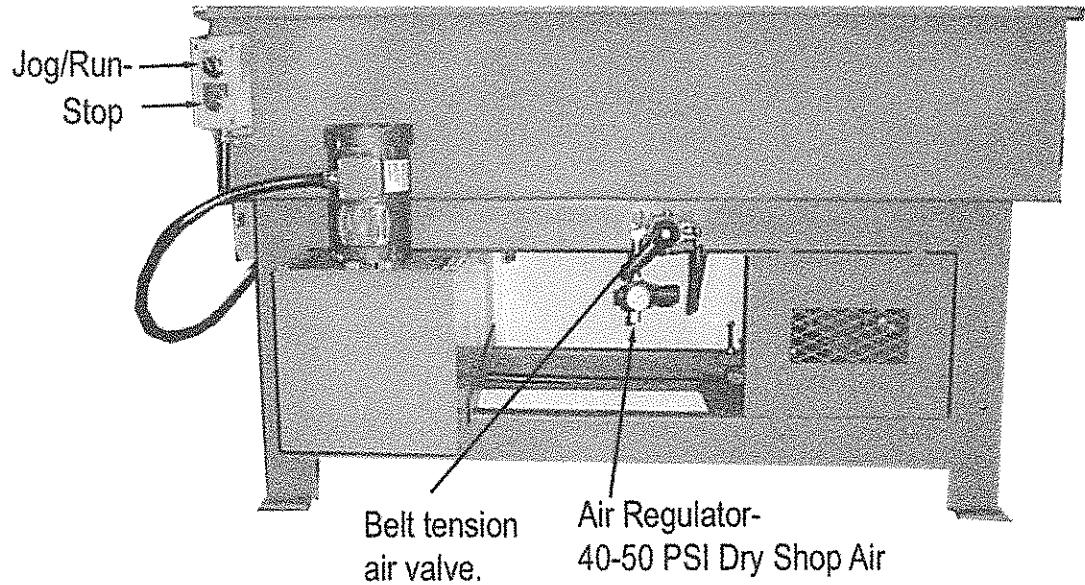

Tracking Knob- Tracks sanding belt.
Rotate knob to center sanding belt.
Use JOG switch to verify tracking before
running. Rotate switch to RUN when
correct tracking is achieved.

Coolant On/ Off (S14HW Only)

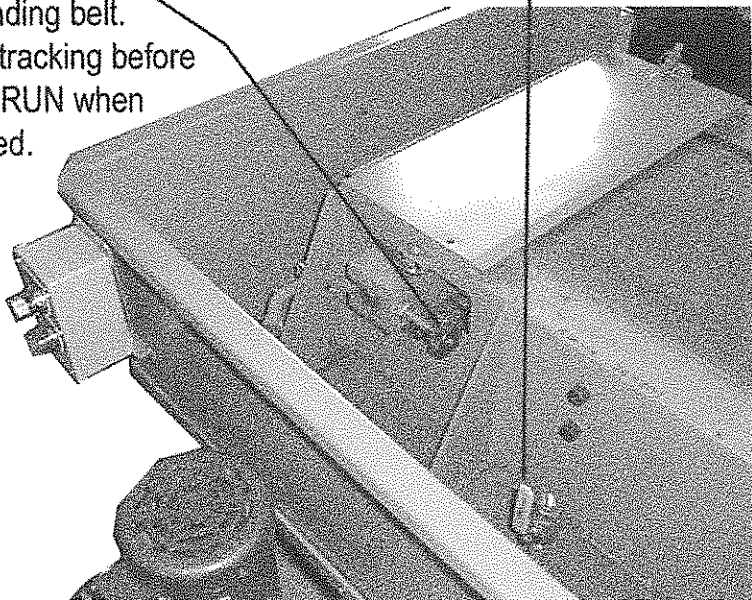

Belt Changing- Turn off power, release belt tension with air valve, remove sanding belt and replace. Re-tension sanding belt with air valve. Re-check tracking using jog/run switch intermittently pushing JOG to center sanding belt. Rotate jog/run switch to RUN to operate machine.

Kalamazoo Ind. Inc. Model # S14HW 14" x 103" Belt, 20 hp. 3ph

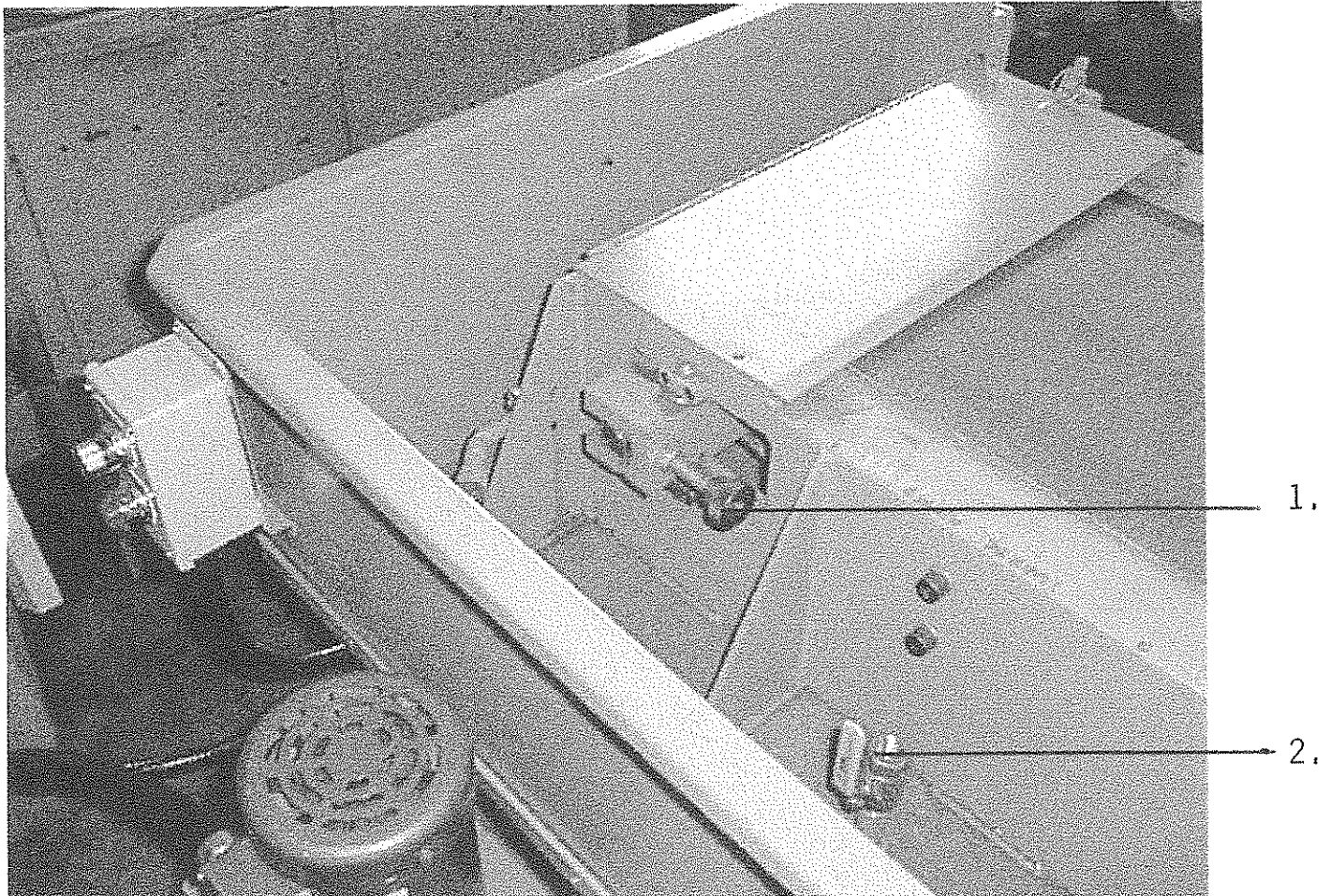

1. Tracking (belt) knob- Clockwise turning of knob moves sanding belt out away from machine frame, Counter-clockwise moves sanding belt towards machine frame. Use jog button to center sanding belt by pushing "jog" button to start belt rotation. When sanding belt is centered on platen use lock nut to lock tracking knob. After using "jog" mode switch over to "run" to rotate sanding belt full time.
(Note: Lock tracking knob when machine is not running!)
2. Coolant outlet/valve- Ball valve turns coolant flow on/off.

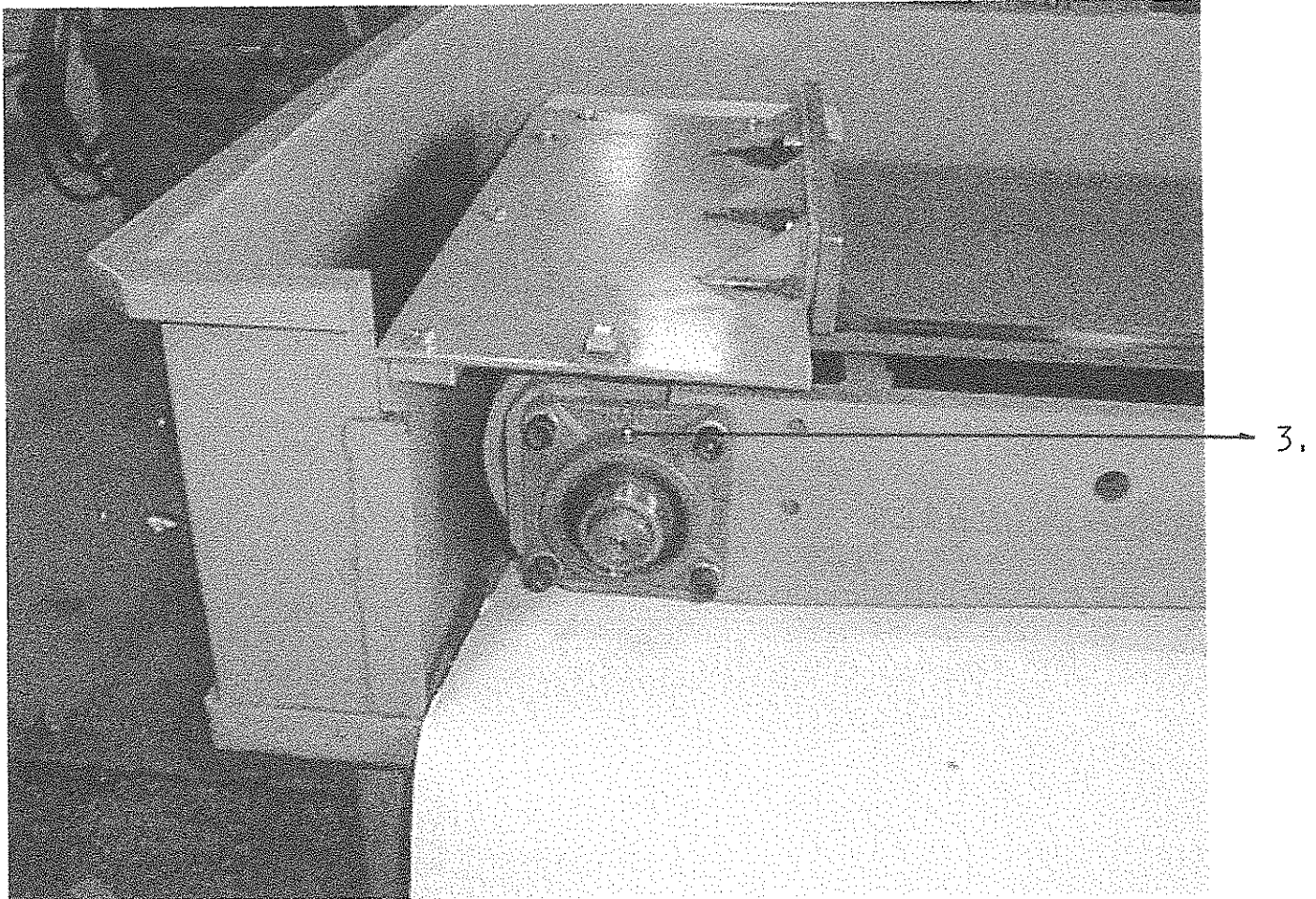

3. Grease fitting- Grease bearing every 8 hrs. of use or more depending on useage. Standard grease is acceptable.

* BE SURE MACHINE IS NOT RUNNING WHEN GREASING!

Side cover of machine must be removed for bearing access.

Belt changing- To change sanding belt remove side cover, release air pressure on belt.(be sure machine is NOT RUNNING when releasing air belt tension). Remove sanding belt by sliding out toward operator. Replace sanding belt .(note correct rotation on inside of belt) Re-tension sanding belt with air valve, re-check belt tracking before operating machine. (Note: tracking air pressure is: 40-50 PSI on gage, over pressure will result in belt breakage and poor tracking)

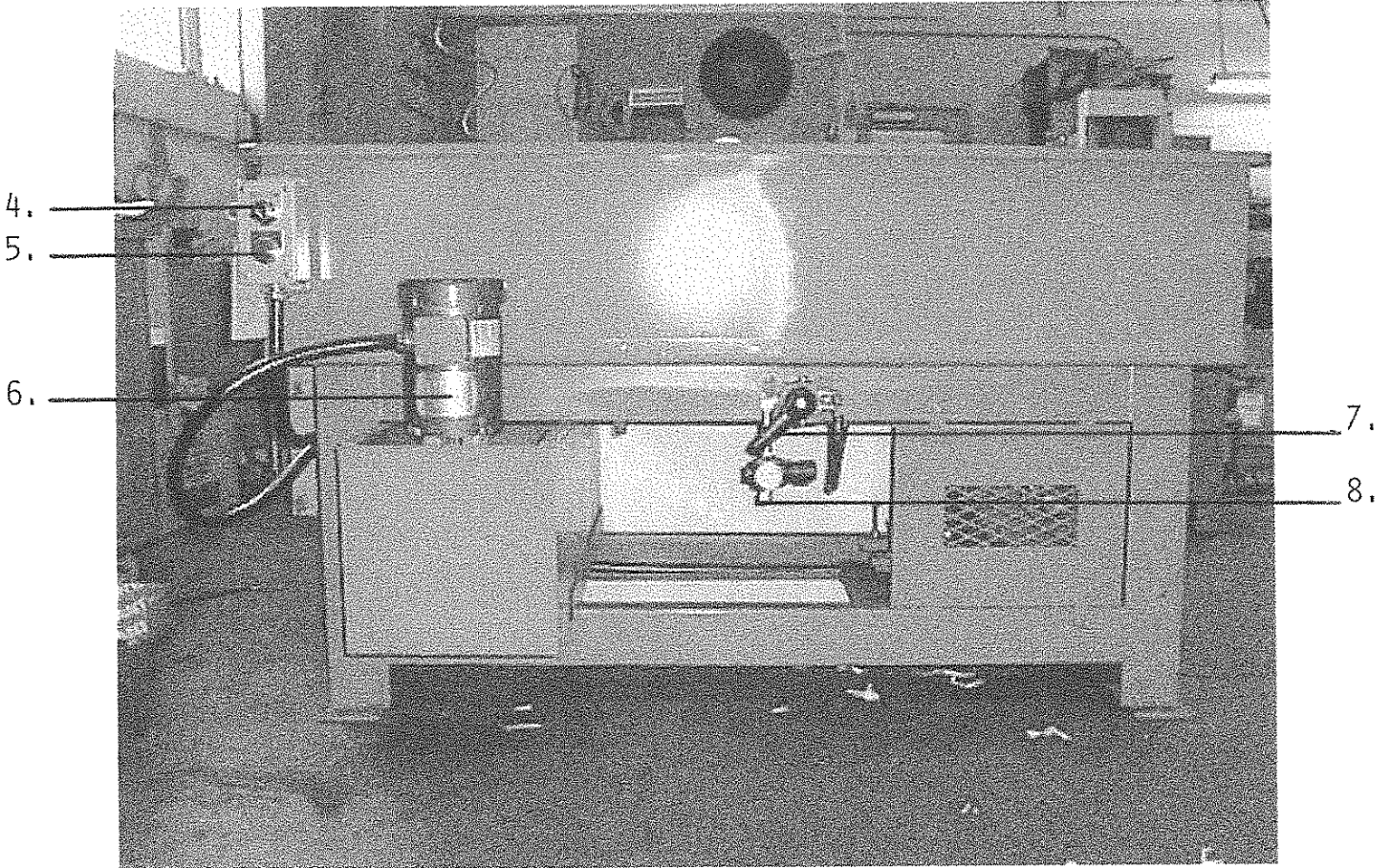

4. Jog/Run Switch- Jog mode runs sanding belt only when button is pushed (intermittent). Run mode runs belt continuously. Use "jog" to test track the belt, then rotate switch to "run".
5. Stop- Stops sanding belt motor/pump motor
6. Pump motor- Pumps coolant to machine. 10 Gal. capacity tank. Use non-rusting type coolant. Clean tank sludge from bottom of tank depending on useage. Control flow with valve (#2).
7. Air valve- Tensions sanding belt. One position for tight belt and another position for slacking the belt.
8. Air regulator- Input shop air here. Keep air tension at 40-50 PSI max. for bewt operation.

Kalamazoo Ind. Inc. Model # S14HW 14" x 103" Belt, 20 hp, 3ph

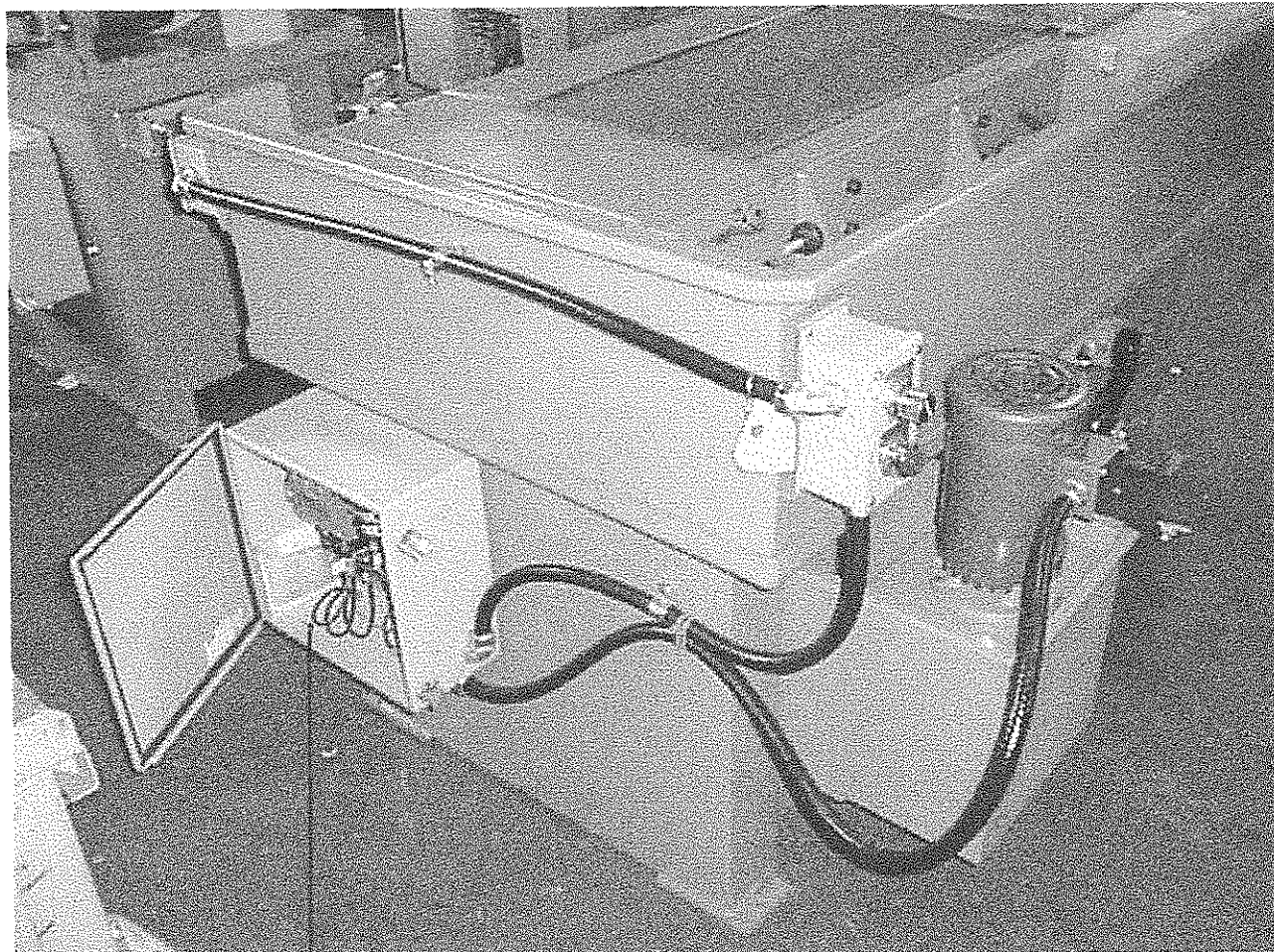

9.

9. Power box- Houses magnetic starter, transformer, electronics. Bring user power into power box. Customer to drill holes and locate per customer standards. Use appropriate fittings per local codes etc..

NDJCR 15hp. 3ph
220Volt or 440Volt

MAGNETIC STARTER
w/ over load protection
& jog button

BELT 14" x 103" PLATEN 14"x 36"

3450 RPM NDJCR - 4,000 SFPM

WORKING HEIGHT (floor to platen) 34"

MDL No. S14 HW

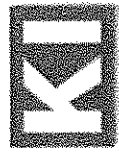

**KALAMAZOO
INDUSTRIES, INC.**

6856 East K Avenue
Kalamazoo, MI 49048
269-382-2050 PH
269-382-0790 FAX
www.kalamazooindustries.com

Emergency Stop Push Button
25gal. Coolant Tank
Pump Motor 1/2Hp 3Ph
Air Tension On Belt 45lbs

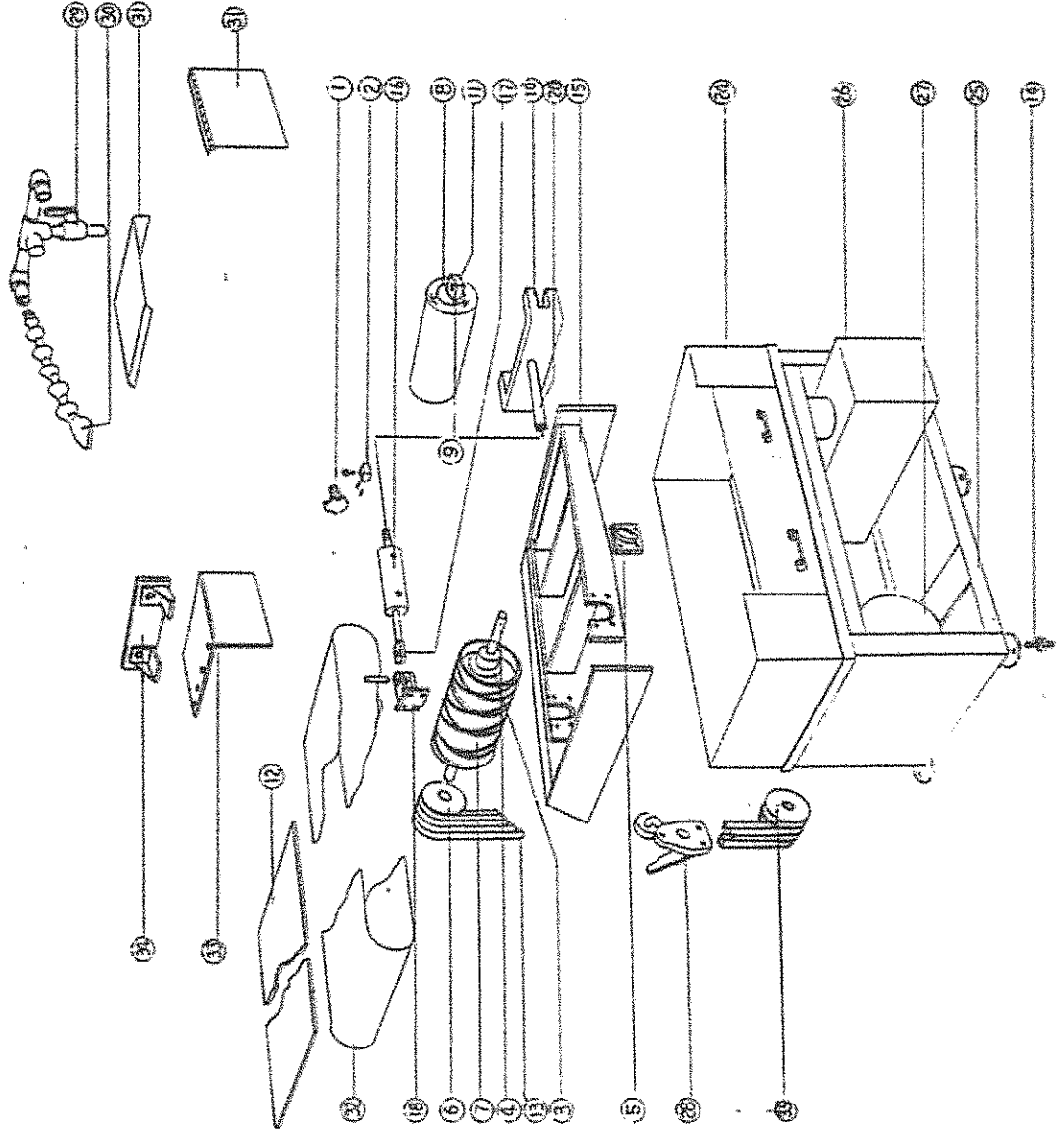

No.	Part No.	Description	QTY
1	441-006	Tracking Knob	2
2	033-008	Adjusting Blocks	2
3	049-011	Sleeve Bushings	2
4	701-038	Drive Spindle	1
5	044-013	Bearing Flange	2
6	560-058	Spindle Pulley	1
	049-023	Spindle Pulley Bushing	1
7	560-041	Drive Pulley	1
8	560-028	Idler Pulley	1
9	044-014	Idler pulley bearing	2
10	960-009	Idler Yoke	1
11	701-036	Idler Spindle	1
12	562-006	Platen	1
13	031-017	V-Belts	4
14	686-018	Leveling Screws	8
15	231-010	Weldment Frame	1
16	131-013	Tension Cylinder	1
17			
18	131-019	Clevis Bracket	1
19			
20	700-010	Idler Yoke Post	1
21			
22			
23			
24			
25	715-068	Stand	1
26	T-19-CB	Pump & Tank	1
27	486-009	20HP 3Ph Motor	1
28	1000-37	Air Reg. Assy	1
29	1000-38	Coolant Hose Assembly	1
30		Nozel Assembly	1
31		Idler Pulley Guard	1
32		14" x 103" Belt	1
33		Drive Pulley Guards	2
34		Work Stop	1
35	560-058	Motor Pulley	1
	049-033	Motor Pulley Bushing	1

SCALE:	DATE: 6-18-90	APPROVED BY:	DRAWN BY: CN
			REVISED:
			DRAWING NUMBER: