

INSTRUCTION MANUAL DS12 & DS12V DISC SANDER



**KALAMAZOO
INDUSTRIES, INC.**

6856 E K Avenue

Kalamazoo, MI 49048

(269) 382-2050 Phone

(269) 382-0790 Fax

www.kalamazooind.com

WARRANTY

All products are guaranteed for a period of one year to the original purchaser, against defects in material workmanship under normal use. Electric motors are warranted by the motor manufacturer and will be repaired by the nearest motor repair station. If non-repairable, they will be replaced by Kalamazoo Industries. Please call for instructions 269-382-2050.

RETURN POLICY

Authorization must be obtained before returning merchandise. Please call our customer service department for a return authorization number at 269-382-2050. Please include with your return a copy of your invoice or packing slip. Materials must be sent back prepaid. (Unless otherwise indicated). All returns will be subject to a 10% restocking charge. No returns will be accepted after one year of invoice date.

DISC SANDER SAFETY

- READ THE OPERATING INSTRUCTIONS BEFORE RUNNING MACHINE.
- ALWAYS WEAR SAFETY GLASSES OR A FULL FACE SHIELD FOR PROTECTION.
- KEEPS HANDS CLEAR OF THE SANDING AREA.
- NEVER WEAR GLOVES OR LOOSE FITTING CLOTHES WHEN OPERATING THIS MACHINE.
- ALWAYS KEEP HAIR TIED BACK OR COVERED.
- LET MACHINE ROTATION COME TO A FULL STOP BEFORE CHANGING BELT.
- KEEP SAFETY GUARDS IN PLACE. DO NOT ALTER GUARDS OR MACHINE IN ANY WAY. ANY ALTERATIONS TO GUARDS OR MACHINE COULD CAUSE SERIOUS INJURY.
- ALL DISC SANDERS SHOULD BE OPERATED IN A WELL-VENTILATED AREA. THE DUST CREATED WHEN SOME MATERIALS ARE SANDED CAN BE HARMFUL. DUST MASKS ARE RECOMMENDED AS A PRACTICAL MEANS OF MINIMIZING DUST INHALATION. FUMES FROM OTHER SOURCES CAN ALSO CAUSE FIRES WHEN IN CONTACT WITH SANDING SPARKS.
- SPARKS CREATED BY SANDING SHOULD BE DIRECTED DOWNWARD AND AWAY FROM THE FACE AND BODY. DO NOT GRIND NEAR FLAMMABLE MATERIAL.
- ELECTRIC SANDING MACHINES ARE NOT INTENDED FOR USE IN OR NEAR WATER. THIS INCLUDES AN OPERATOR STANDING ON A WET FLOOR OR WORKING AROUND CONTAINERS OF WATER OR OTHER CONDUCTIVE LIQUIDS.

KALAMAZOO INDUSTRIES, INC.
6856 East K Avenue
Kalamazoo, MI 49048
269-382-2050 PH
269-382-0790 FAX
www.kalamazooindustries.com



Made in USA

DISC SANDER SAFETY CONTINUED VACUUM BASE

INSTRUCTIONS FOR DS12V VACUUM BASE

- Thoroughly clean vacuum base daily and prior to sanding different materials.
- **DON'T** mix materials. Mixing materials will start a fire in the vacuum cabinet.
- Change cloth filter (5X878) at least once a week or when sanding different materials.
- Read over owner's manual prior to using the equipment

OPTIONAL

- Fire proofed cloth filter available (5X878FP)



6856 E K Avenue
Kalamazoo, MI 49048
(269) 382-2050 Phone
(269) 382-0790 Fax
www.kalamazooind.com

BASIC OPERATION

Motor Specifications: 1HP 1PH 115V/230V 1725 RPM
FLA: 115V:12.8 Amps 230V: 6.4 Amps

Disc Size: 12"

1. Be sure AC incoming power matches the DS12 12" disc sander. The DS12 ships standard as 1PH 115V. The motor is dual voltage so it can be wired to 1PH 230V if needed at the motor junction box. An electrical schematic sticker on the motor indicates the wiring for voltage changes. **CAUTION: IF YOUR NOT FAMILIAR WITH ELECTRICS CONSULT AN ELECTRICIAN.**
2. Disc: The 12" disc uses PSA (pressure sensitive adhesive) discs. Peel back the clear backing and stick the disc to the aluminum disc holder. Consult your dealer for different PSA disc grits.
3. Disc stable: The disc table will tilt downward for angles. Loose the knobs #6 on left and right side of work table to adjust angle of work table, re-lock to maintain desired position. Keep the work table within 1/8" of the disc for safety.
4. Clean out vacuum prior to sanding different material.
5. Follow **ALL** safety procedures. **SEE SAFETY SHEET.**

THOROUGHLY CLEAN YOUR DISC SANDER AND VACUUM BASE DAILY TO HELP EXTEND THE LIFE OF THE UNIT! BELOW IS A SIGN OFF SHEET TO HELP YOU KEEP TRACK WHEN YOU CLEANED THE MACHINE!

[illegible]

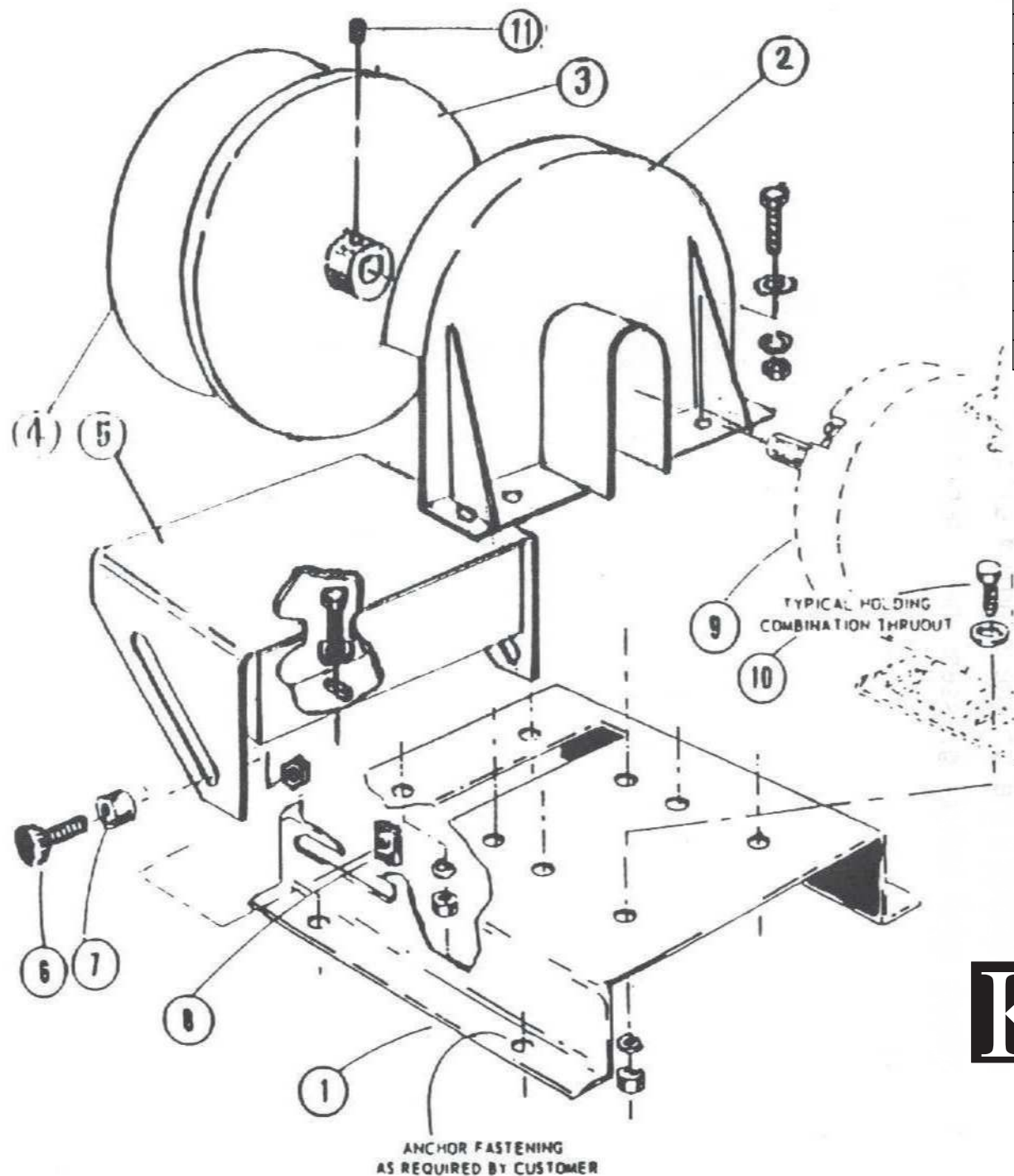

ITEM	PART NUMBER	DESCRIPTION	QTY
1	050-029	BASE	1
2	342-034	DISC GUARD	1
3	160-002	ALUMINUM DISC	1
4	KD1250	12" 50 GRIT DISC	1
4	KD1280	12" 80 GRIT DISC	1
4	KD12100	12" 100 GRIT DISC	1
5	829-016	TABLE ASSY.	1
6	441-017	LOCKING KNOB	2
7	-	SPACER	2
8	-	WELD NUT	2
9	486-013	1HP 1PH	1
10	-	MOUNTING SCREWS	8
11	-	SET SCREW	1

KI KALAMAZOO
INDUSTRIES, INC.

6856 E K Ave
Kalamazoo, MI 49048
(269) 382-2050 Phone
(269) 382-0790 Fax
www.kalamazooind.com

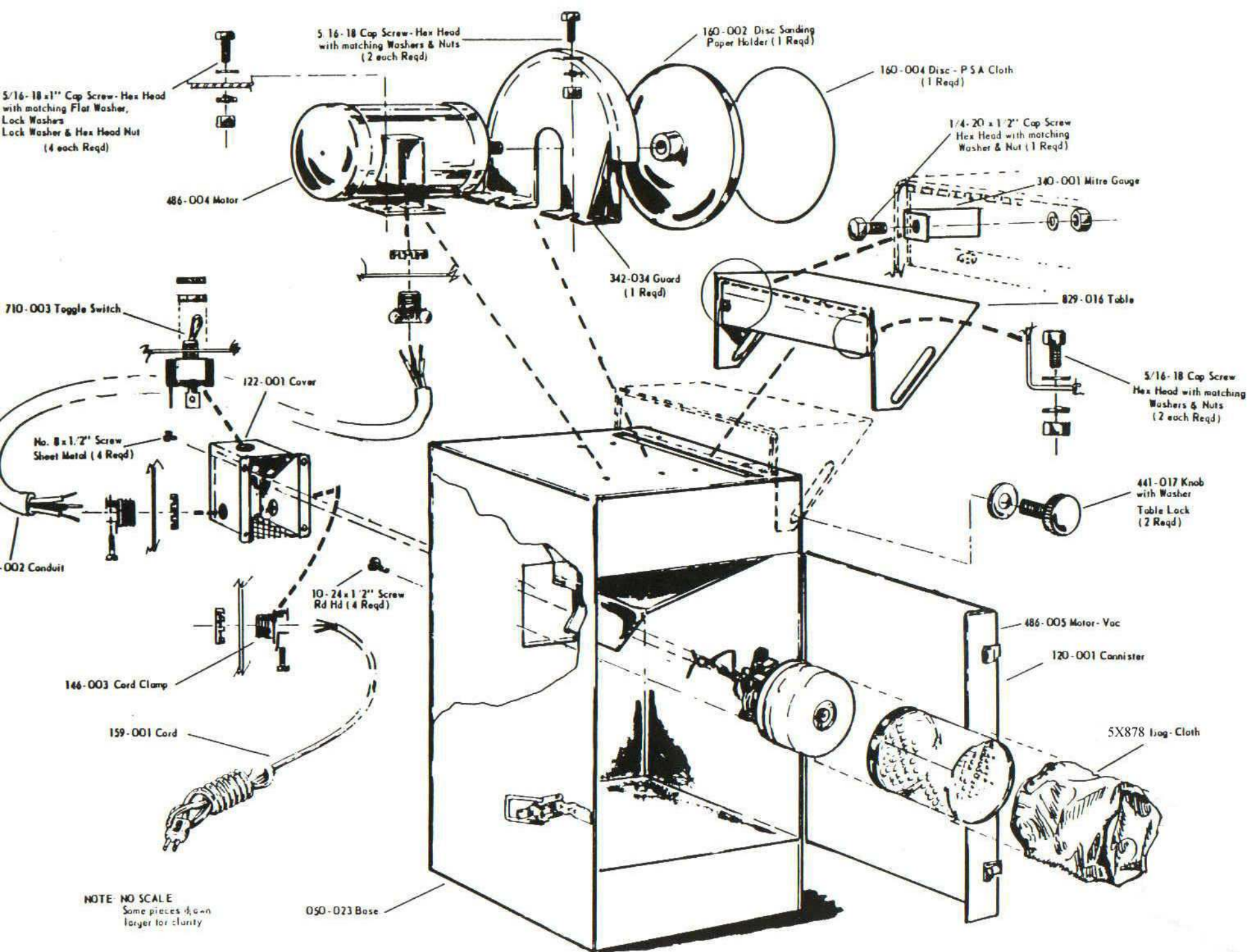

ABRASIVE SAWS • BELT SANDERS • INDEXING HEADS
KALAMAZOO INDUSTRIES INC., 4855 E. MICHIGAN, KALAMAZOO, MI 49003
P.O. BOX 2558 PHONE 16161 382-2050

Model DS-12V